

# Homestead Implements Pinnacle Series Landscape Rake

## Technical Specification

| Model Numbers       | HI-P-LR-60                                                                                                                                                               | HI-P-LR-72                            | HI-P-LR-84          |
|---------------------|--------------------------------------------------------------------------------------------------------------------------------------------------------------------------|---------------------------------------|---------------------|
| Working Width       | 60" (1.52m)                                                                                                                                                              | 72" (1.82m)                           | 84" (2.13m)         |
| Height and Length   | 37.38"(0.95 m) Height & 42.38"(1.07m) Length                                                                                                                             |                                       |                     |
| Weight              | 235 lbs<br>(107 kg)                                                                                                                                                      | 263 lbs<br>(119 kg)                   | 285 lbs<br>(130 kg) |
| Number of Tines     | 30                                                                                                                                                                       | 36                                    | 42                  |
| Park Stand          | Retractable w/ Pin                                                                                                                                                       |                                       |                     |
| Pivot Joint         | 2 3/8" (6.0cm) OD tube                                                                                                                                                   |                                       |                     |
| Rake Angle          | Forward Position - 15°, 30° and 45° Clockwise and counter-clockwise<br>Reverse Position - 15° and 30° Clockwise and counter-clockwise                                    |                                       |                     |
| Lift Mechanism      | Lower lift arms 1/2" Plate mounted on 4" x 4" x 3/16" (10.2cm x 10.2cm x 4.8mm) tube and upper lift arms 1/4" Plate mounted on 2" x 3" x 3/16" (10.2cm x 10.2cm x 4.8mm) |                                       |                     |
| Tine Dimensions     | 1"(25.4mm) Wide x 5/16" (7.9mm) Thick                                                                                                                                    |                                       |                     |
| Tine Position       | 1"(25.4mm) Apart                                                                                                                                                         |                                       |                     |
| Tine Material       | High-Carbon Spring steel with quenching                                                                                                                                  |                                       |                     |
| Tine Replacement    | Individual (Call 833-625-0635 for Replacement Tines)                                                                                                                     |                                       |                     |
| Maximum H.P. Rating | 55 HP                                                                                                                                                                    |                                       |                     |
| 3-Point Hitch Type  | Cat. 1 Quick-Hitch Compatible                                                                                                                                            | Category 1 & 2 Quick-Hitch Compatible |                     |

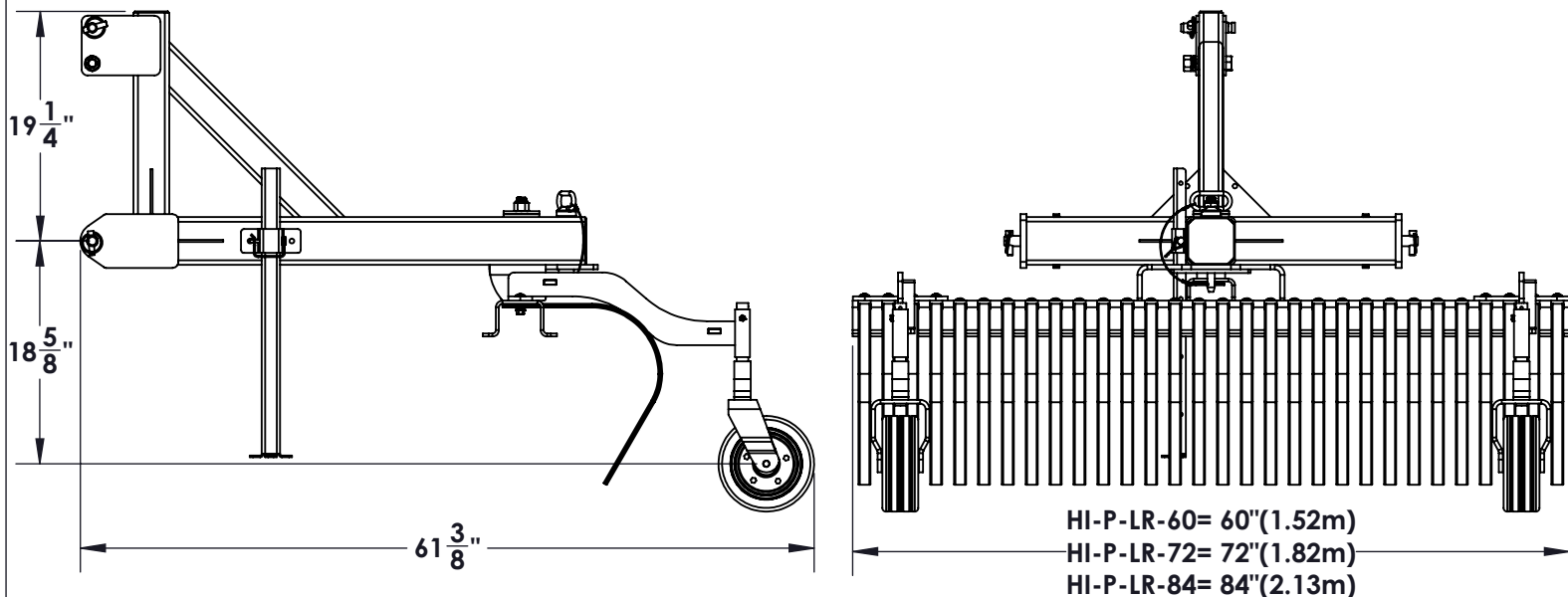

CUSTOMER APPROVAL :

DATE :



THIS DRAWING, WHICH CONTAINS PROPRIETARY INFORMATION, IS THE PROPERTY OF JAMESTOWN ADVANCED PRODUCTS CORPORATION. IT SHALL NOT BE REPRODUCED IN ANY MANNER NOR DISCLOSED TO THIRD PARTIES WITHOUT WRITTEN PERMISSION OF JAMESTOWN ADVANCED PRODUCTS CORPORATION.

PRODUCT PART NUMBER : **HI-P-LR**

PRODUCT DESCRIPTION : **LANDSCAPE RAKE**

DATE : 08/13/2022

REV. NO.

2855 GIRTS ROAD  
JAMESTOWN, NY 14701

PHONE 833-625-0635 -- FAX 716-483-5398 -- WWW.HOMESTEADIMPLEMENTS.COM

Product Weight: 22lbs per side (44lbs Total)

Packaging Size: 28" x 18" x 12"

Tire Width: 3 3/4"

Tire Height: 8"

Tire Material: Solid Rubber

Grease Zerks: 1 Per Side

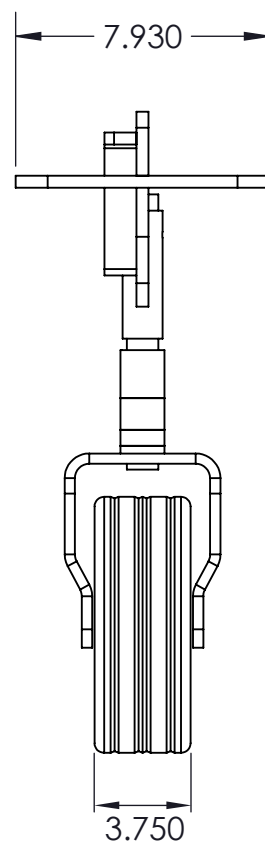
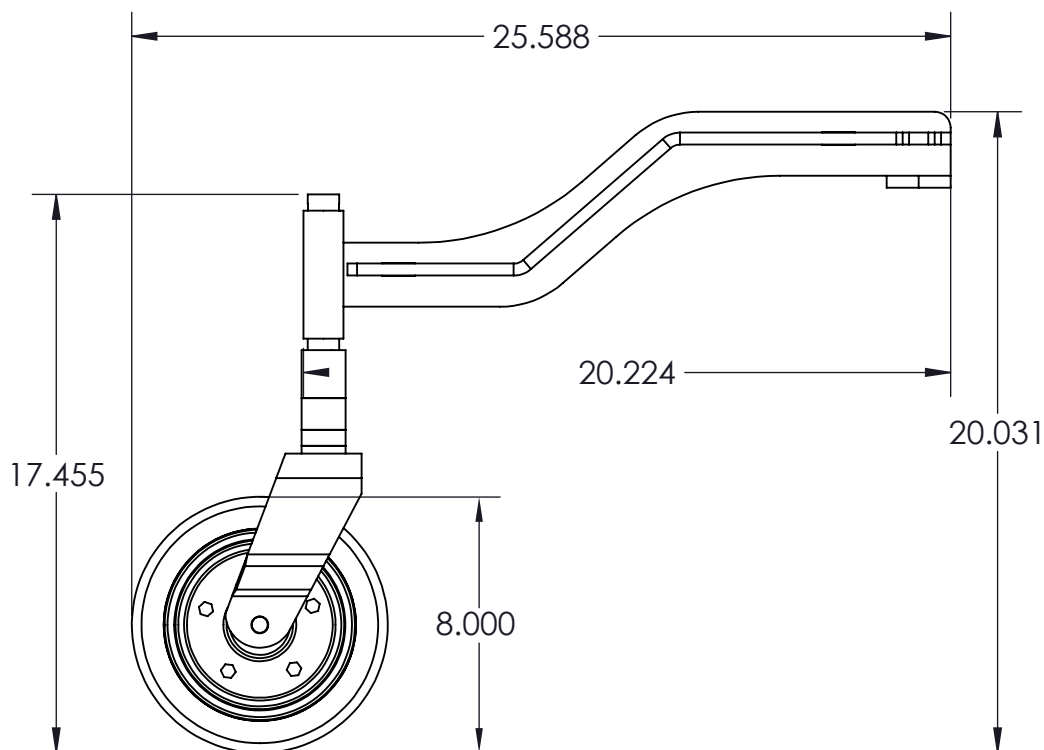
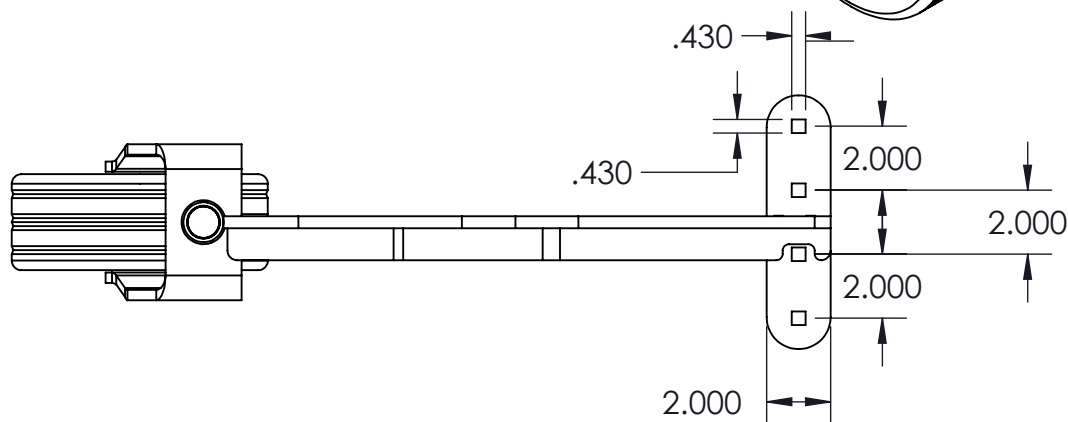
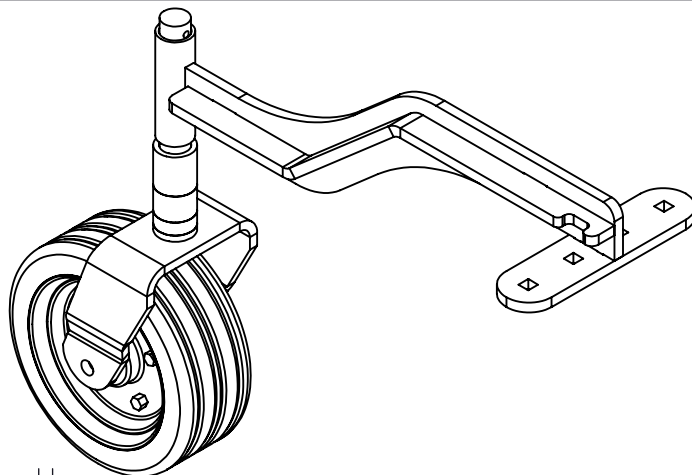

THIS DRAWING, WHICH CONTAINS PROPRIETARY INFORMATION, IS THE PROPERTY OF JAMESTOWN ADVANCED PRODUCTS CORPORATION. IT SHALL NOT BE REPRODUCED IN ANY MANNER NOR DISCLOSED TO THIRD PARTIES WITHOUT WRITTEN PERMISSION OF JAMESTOWN ADVANCED PRODUCTS CORPORATION.

PRODUCT PART NUMBER: HI-P-LR

PRODUCT DESCRIPTION: WHEEL KIT

DATE : 08/13/2022

REV. NO.

2855 GIRTS ROAD  
JAMESTOWN, NY 14701

PHONE 833-625-0635 -- FAX 716-483-5398 -- WWW.HOMESTEADIMPLEMENTS.COM